

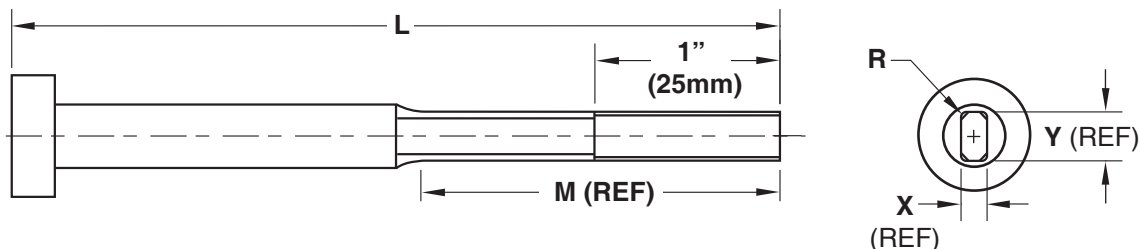

MOLD-READY™ BLADE EJECTORS

Progressive offers Blade Ejectors with mold-ready features including cut-to-length, keyed, with radii, or any combination--including engraving for cavity or blade identification.



How to Order: Create the item number by adding the specific features as noted below.

Specification	Designation	Examples	Tolerance	
			Inch	MM
Cut to Length (CTL)	Specify the length required after the "L": LX.XXX	BE125-046 L4.250 (inch) BE8-2.0 L92.5 (metric)	+0.001 -0.000	+0.025 -0.000
Keyed (Parallel to Blade. See below.)	Tangent to the Blade diameter (D): Specify -K after the length whether CTL or standard.	BE125-046L4.250- K (inch) BE8-2.0L92.5- K (metric)	+0.000 -0.002	+0.000 -0.050
	Distance from center: Specify -KXXX and the dimension required after the length.	BE125-046L4.250- K.094 (inch) BE8-2.0L92.5- K3.5 (metric)		
Radii (4) (For 1" length. See below.)	After the length or key is specified, add -RXXX and the size of the radius required. (Minimum Radius=.010"/.25mm)	BE125-046L4.250- R.020 or BE125-046L4.250-K.094- R.020 (inch) BE8-2.0L92.5- R.5 or BE8-2.0L92.5-K3.5- R.5 (metric)	±.0005	±.012
Engraved on Head	Up to 4 characters, specify -(EOH:X) where "X" is the required character(s) on the single blade.	BE125-046L4.250-R.012- EOH:2 BE125-046L4.250-K.094-R.012- EOH:347 (in.) BE8-2.0L92.5-R.5- EOH:2 or BE8-2.0L92.5-K3.5-R.5- EOH:347 (metric)	N/A	

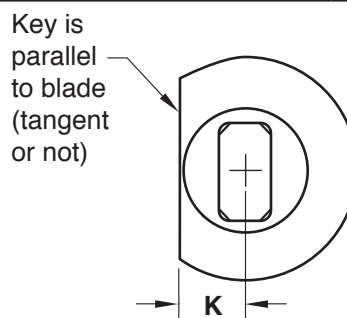
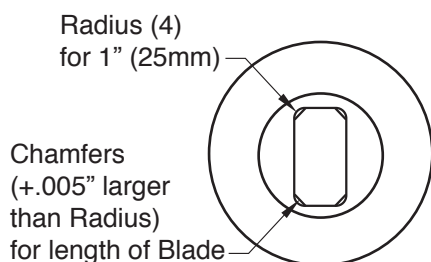

MADE-TO-ORDER CUSTOM BLADE EJECTORS

Progressive can provide custom, finished blades per print, template, or CAD model.

Additional services include:

- Two radii (on same side) for blades near inserts.
- Longer land for the radii (2 or 4) up to 2" (50mm).
- Alternate materials or sizes (D/X/Y/L) outside of the standard Blade Ej catalog range.
- Black nitriding is an option when H-13 or M-2 material is used.

For a quote, send your request to tech@procomps.com. Templates are available online.