

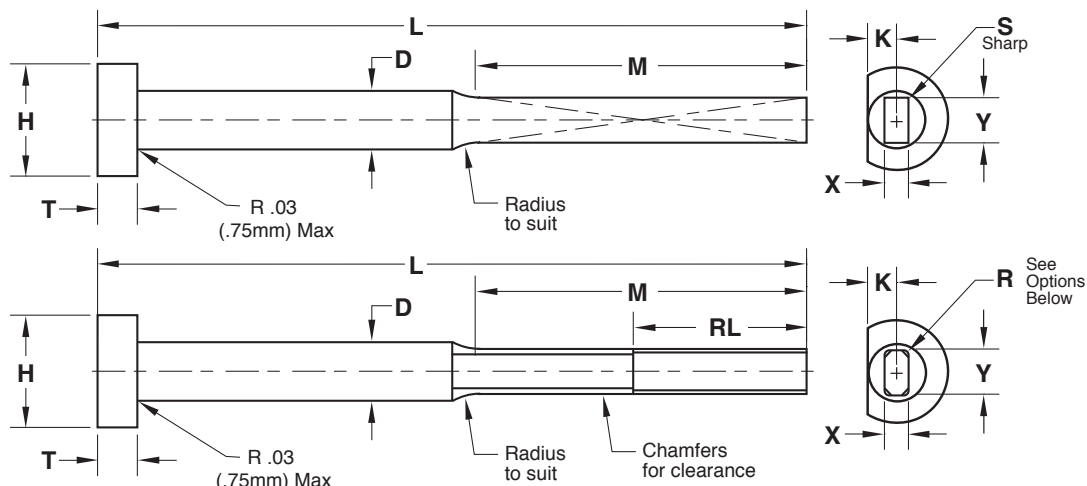

BLADE EJECTORS

STANDARD TOLERANCES		
X	+0.0000 -0.0005	+0.000 -0.015
Y	+0.0000 -0.0005	+0.000 -0.015
D	+0.000 -0.001	+0.00 -0.02
L	+0.04 -0.00	+1.0 -0.0
M	+0.04 +0.08	+1.0 +2.0
H	+0.000 -0.010	+0.0 -0.2
T	+0.000 -0.002	+0.00 -0.05
K	+0.000 -0.002	+0.00 -0.05
	INCH	METRIC



Material:

- O-1 58-62 HRC (Thru Hard)
 H-13 48-52 HRC (Thru Hard)
 M-2 58-62 HRC (Thru Hard)
 Black Nitride (H-13/M-2 Only)
 Nicklon

Treatment:

BLADE DIMENSIONS			
Dimension	Tolerance		
X	<input type="checkbox"/> Standard	+	
		-	
Y	<input type="checkbox"/> Standard	+	
		-	
D	<input type="checkbox"/> Standard	+	
		-	
L	<input type="checkbox"/> Standard <input type="checkbox"/> Finished Length (+.001/- .000 or +.025mm/-0)	+	
		-	
M	<input type="checkbox"/> Standard	+	
		-	
H	<input type="checkbox"/> Standard	+	
		-	
T	<input type="checkbox"/> Standard	+	
		-	
K	From Center <input type="checkbox"/> Tangent to Diameter (Will be parallel to Y dim.)	(Optional)	

CORNER SPECIFICATIONS			
Dimension	Min/Max Specifications & Tolerances		
S	<input type="checkbox"/> Sharp		
2R	2 Corner Radii (.01"/.25mm minimum) <input type="checkbox"/> Horizontal <input type="checkbox"/> Vertical		± .0005
4R	4 Corner Radii (.01"/.25mm minimum)		± .0005
RL	Radius Length (2"/50mm maximum) Chamfers for clearance will be +.005"/.13mm larger than the 2 or 4 radii specified.)		+ .125 - .000

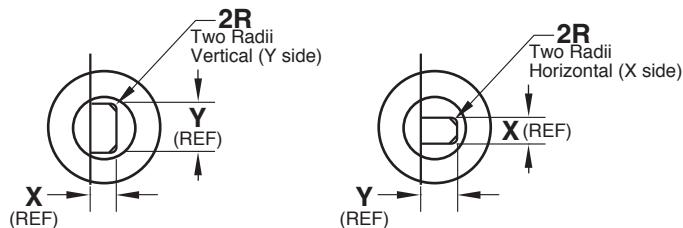

Quantity:	Engraving (Specify up to 4 digits)
------------------	--

E-MAIL TECH@PROCOMPS.COM		
CONTACT:	COMPANY NAME:	PHONE #:
REFERENCE #:	ACCOUNT #:	E-MAIL ADDRESS: