



Precision Fit, Proven Performance

Progressive's Ejector Pins are engineered and manufactured to meet the demanding conditions of today's injection molds. Made from premium materials and competitively priced, our pins lead the pack in consistent, accurate, and lab-proven performance.



Maximum Performance

Progressive Ejector Pins are designed to last. Rigorous performance testing and analysis by an independent testing facility have proven that Progressive's pins are superior to other brands.

The smooth, micro-finished Ion Nitride surface of Progressive's Ejector Pins reduces hole wear and damage that can result in costly mold repair. See the photo of the lab test below. After almost 1,700 cycles, the surface failed on all but the Progressive pins.*

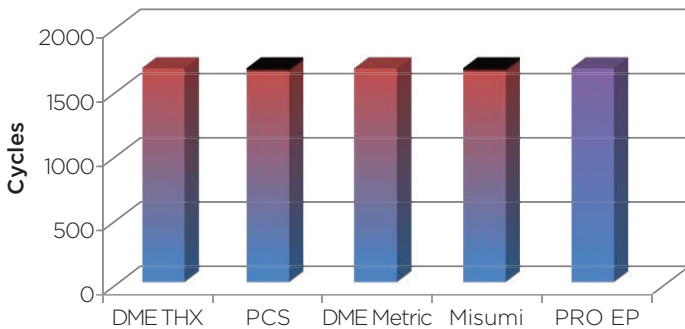

Reduced Failures

Every Progressive Ejector Pin is through-hardened H-13, precision ground, and micro-finished for maximum wear resistance. Unlike other brands, we utilize a process that allows for a more gradual hardness transition from the case to the 48-50 HRC core, eliminating dishing, nicking, and chipping.

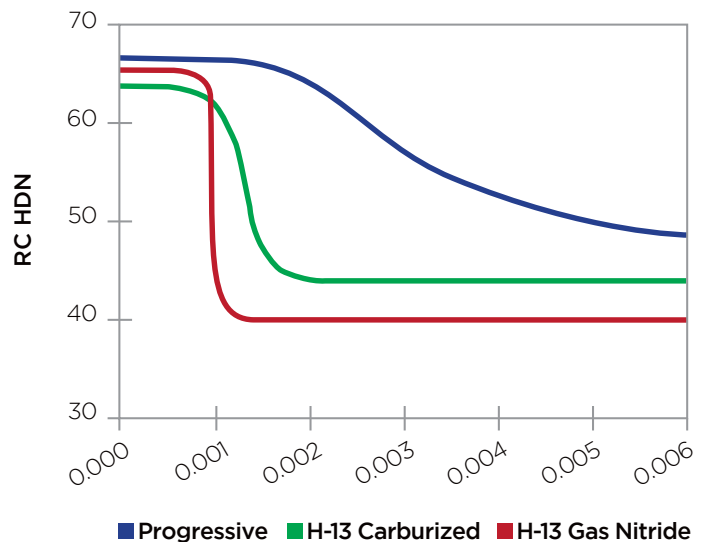

Consistent Quality

Progressive stands by our commitment to "No Made in China" products. Therefore our Ejector Pins are engineered and manufactured to the highest quality standards creating the tightest tolerances on the market and eliminating the need for additional hole sizing.

Summary of Independent Test Results

- The test was stopped at 1,706 cycles because the load required to move the pins increased to the limit of the test machine.
- Heavy galling was seen on Sample 2 (PCS) and Sample 4 (Misumi) at 1,706 cycles.
- Wear and galling were seen on Sample 1 (DME THX) and 3 (DME Metric) at 1,706 cycles.
- Burnishing of the surface appearance was seen on Sample 5 (Pro EP 1) and Sample 6 (Pro EP 2) at 1,706 cycles, but no galling or dimensional loss was observed.

Access the complete lab testing results, testimonials, catalog pages, and more at procomps.com/Pins.

*Testing performed by an independent service.

All company and product names mentioned are the property of their respective owners.



EJECTOR PINS

THROUGH-HARD PINS: STRAIGHT-INCH STANDARD



D Tolerances	
Ø3/64 - Ø7/16	-.0004 -.0007
Ø15/32 and Up	-.0004 -.0009

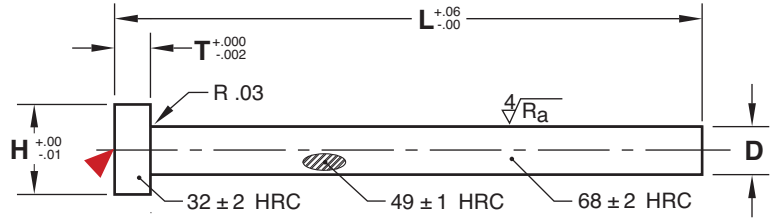

M H-13 **H** Core: 48-50 HRC, Surface: 66-70 HRC

▶ CAD insertion point

D NOMINAL PIN DIAMETER	H	T	L=6"		L=10"		L=14"		L=18"		L=25"		L=39"	L=50"
			D STANDARD	D STANDARD	D .005 OVERSIZE	D STANDARD	D .005 OVERSIZE	D STANDARD	D .005 OVERSIZE	D STANDARD	D .005 OVERSIZE	D STANDARD	D STANDARD	
1/32	.25	.125	EP031L6	—	—	—	—	—	—	—	—	—	—	—
3/64	.25	.125	EP047L6	—	—	—	—	—	—	—	—	—	—	—
1/16	.25	.125	EP062L6	EP062L10	—	—	—	—	—	—	—	—	—	—
5/64	.25	.125	EP078L6	EP078L10	—	—	—	—	—	—	—	—	—	—
3/32	.25	.125	EP094L6	EP094L10	—	—	—	—	—	—	—	—	—	—
7/64	.25	.125	EP109L6	EP109L10	EP114L10	—	—	—	—	—	—	—	—	—
1/8	.25	.125	EP125L6	EP125L10	EP130L10	EP125L14	EP130L14	EP125L18	—	EP125L25	—	—	—	—
9/64	.25	.125	—	EP141L10	—	EP141L14	EP146L14	—	—	—	—	—	—	—
5/32	.28	.156	EP156L6	EP156L10	EP161L10	EP156L14	EP161L14	EP156L18	—	EP156L25	—	—	—	—
11/64	.34	.187	—	EP172L10	—	EP172L14	EP177L14	—	—	—	—	—	—	—
3/16	.37	.187	EP187L6	EP187L10	EP192L10	EP187L14	EP192L14	EP187L18	—	EP187L25	—	EP187L39	EP187L50	—
13/64	.37	.187	—	EP203L10	—	EP203L14	EP208L14	—	—	—	—	—	—	—
7/32	.40	.187	EP219L6	EP219L10	EP224L10	EP219L14	EP224L14	—	—	EP219L25	—	—	—	—
15/64	.40	.187	—	EP234L10	—	EP234L14	EP239L14	—	—	—	—	—	—	—
1/4	.43	.187	EP250L6	EP250L10	EP255L10	EP250L14	EP255L14	EP250L18	EP255L18	EP250L25	—	EP250L39	EP250L50	—
17/64	.43	.250	—	EP266L10	—	EP266L14	EP271L14	—	—	EP266L25	—	—	—	—
9/32	.43	.250	EP281L6	EP281L10	EP286L10	EP281L14	EP286L14	EP281L18	EP286L18	EP281L25	—	—	—	—
19/64	.50	.250	—	EP297L10	—	EP297L14	EP302L14	—	—	—	—	—	—	—
5/16	.50	.250	EP312L6	EP312L10	EP317L10	EP312L14	EP317L14	EP312L18	EP317L18	EP312L25	EP317L25	EP312L39	EP312L50	—
21/64	.56	.250	—	EP328L10	—	EP328L14	EP333L14	—	—	EP328L25	—	—	—	—
11/32	.56	.250	EP344L6	EP344L10	EP349L10	EP344L14	EP349L14	—	—	EP344L25	—	—	—	—
23/64	.62	.250	—	EP359L10	—	EP359L14	EP364L14	—	—	—	—	—	—	—
3/8	.62	.250	EP375L6	EP375L10	EP380L10	EP375L14	EP380L14	EP375L18	EP380L18	EP375L25	EP380L25	EP375L39	EP375L50	—
25/64	.62	.250	—	—	—	EP390L14	EP395L14	EP390L18	—	—	EP395L25	—	—	—
13/32	.68	.250	EP406L6	EP406L10	EP411L10	EP406L14	EP411L14	EP406L18	—	EP406L25	—	—	—	—
27/64	.68	.250	—	—	—	EP422L14	EP427L14	—	—	—	—	—	—	—
7/16	.68	.250	EP437L6	EP437L10	EP442L10	EP437L14	EP442L14	EP437L18	—	EP437L25	—	EP437L39	EP437L50	—
29/64	.68	.250	—	—	—	EP453L14	EP458L14	—	—	—	—	—	—	—
15/32	.75	.250	—	EP469L10	EP474L10	—	EP474L14	EP469L18	—	EP469L25	—	—	—	—
31/64	.75	.250	—	—	—	EP484L14	EP489L14	—	—	—	—	—	—	—
1/2	.75	.250	EP500L6	EP500L10	EP505L10	EP500L14	EP505L14	EP500L18	—	EP500L25	EP505L25	EP500L39	EP500L50	—
17/32	.75	.250	—	—	—	EP531L14	EP536L14	—	—	EP531L25	—	—	—	—
9/16	.81	.250	EP562L6	EP562L10	—	EP562L14	—	EP562L18	—	EP562L25	—	EP562L39	EP562L50	—
5/8	.87	.250	EP625L6	EP625L10	—	EP625L14	—	EP625L18	—	EP625L25	—	EP625L39	EP625L50	—
11/16	.93	.250	—	EP687L10	—	—	—	EP687L18	—	EP687L25	—	—	—	—
3/4	1.00	.250	EP750L6	EP750L10	—	EP750L14	—	EP750L18	—	EP750L25	—	EP750L39	EP750L50	—
7/8	1.12	.250	—	EP875L10	—	EP875L14	—	EP875L18	—	EP875L25	—	EP875L39	EP875L50	—
1	1.25	.250	EPI000L6	EPI000L10	—	EPI000L14	—	EPI000L18	—	EPI000L25	—	EPI000L39	EPI000L50	—

ALTERNATIVE CONFIGURATIONS AVAILABLE

- To order pins with the keys tangent to the diameter, add "-K" to the end of the catalog number. Ex. EP250L10-K.
- Mold-Ready™ Ejector Pins can be supplied cut-to-length, keyed, and/or engraved at a standard price and delivery. Refer to page A-20 and procomps.com/mold-ready for more information.