

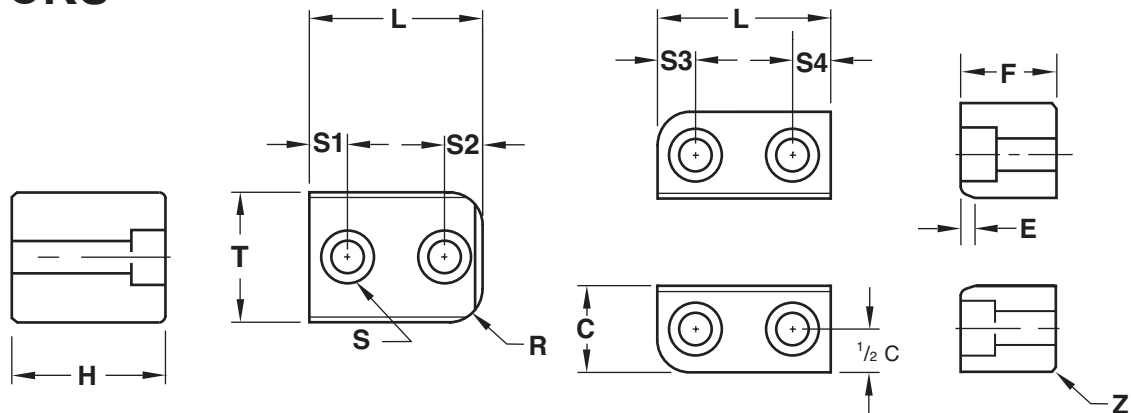

GUIDE LOCKS

Z-SERIES™



STANDARD TOLERANCES		
L	+0.000 -0.010	+0.00 -0.25
H	+0.00 -0.01	+0.0 -0.2
T	+0.0000 -0.0003	+0.00 -0.01
C	+0.0000 -0.0003	+0.00 -0.01
F	+0.000 -0.005	+0.00 -0.12
S1-4	±0.01	±0.2
	INCH	METRIC

Male Insert
 Material = H-13
 Core = 42-48 HRC
 Surface = 70 HRC
 Treatment = Salt Bath Nitride

Female Insert
 Material = D-2
 Core = 58-62 HRC
 Surface = 80 HRC
 Treatment = Titanium Nitride Coated

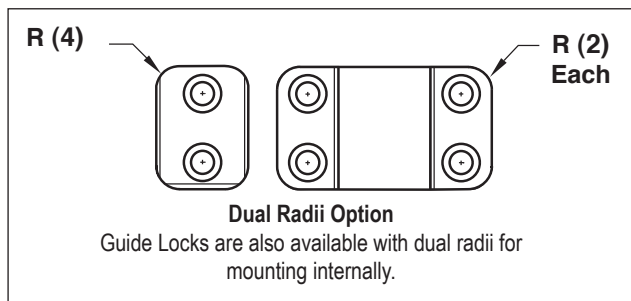

GUIDE LOCK				R	<input type="checkbox"/> To Suit Pocket Radius (Lock machined to suit)	DUAL RADII	<input type="checkbox"/> Yes <input type="checkbox"/> No	
Dimension	Tolerance							
L	<input type="checkbox"/> Standard	+	Z	<input type="checkbox"/> Standard	+			
		-			-			
H	<input type="checkbox"/> Standard	+	S	SHCS				
		-						
T	<input type="checkbox"/> Standard	+	S1					Quantity (Sets of 1M/2F):
		-						
C	<input type="checkbox"/> Standard	+	S2					
		-						
F	<input type="checkbox"/> Standard	+	S3			Qty Male:		
		-				Qty Female:		
E	<input type="checkbox"/> To Suit	Engagement Radius	S4			Qty Female:		

E-MAIL TECH@PROCOMPS.COM

CONTACT:	COMPANY NAME:	PHONE #:
REFERENCE #:	ACCOUNT #:	E-MAIL ADDRESS: