



UNILIFTER® CORE BLADES

STANDARD TOLERANCES		
T	+0.000	+0.0
	-0.001	-0.025
W	+0.000	+0.0
	-0.001	-0.025
L	+0.06	+2.0
	-0.00	-0.0
	INCH	METRIC

Series	R	MT*	MW
MiniLifter	.250	.31	.24
UniLifter	.406	.49	.49
XL Series	.875	1.00	1.00
Metric	10mm	15mm	10mm
Metric Mini	12mm	6mm or T	6mm

*Note: MT may increase for strength.
 Note: Altering the MT & MW dimensions (Minimum Thickness and Width of heel area) is not recommended.

Series:

- | | |
|--|--|
| <input type="checkbox"/> MiniLifter
U-Coupling = UCM50 | <input type="checkbox"/> UniLifter
U-Coupling = UCU87 |
| <input type="checkbox"/> Metric MiniLifter
U-Coupling = UCMM16 | <input type="checkbox"/> XL Series
U-Coupling = UCX175 |
| <input type="checkbox"/> Metric
U-Coupling = UCMM22 | |

Material:

- | | |
|--|---|
| <input type="checkbox"/> H-13
Hardness = 38-42 HRC | <input type="checkbox"/> S-7
Hardness = 54-56 HRC |
| <input type="checkbox"/> H-13
Hardness = 48-50 HRC | <input type="checkbox"/> S-7 with Assembly Detent
(For C-Series Applications.
Not available in XL Series.) |
| <input type="checkbox"/> DC53
Hardness = 58-60 HRC | |

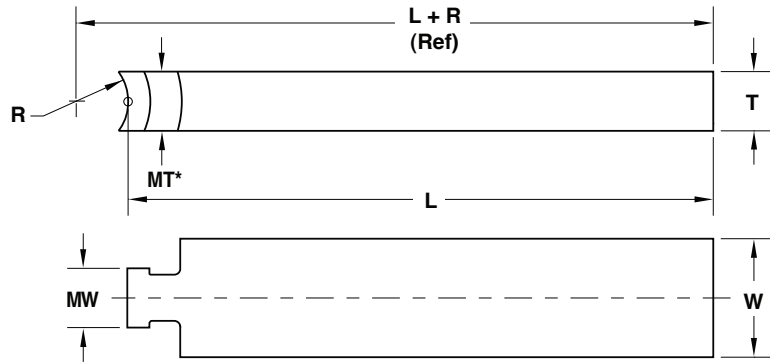

CORE BLADE #1			
Dimension		Tolerance	
T		<input type="checkbox"/> Standard	+
			-
W		<input type="checkbox"/> Standard	+
			-
L		<input type="checkbox"/> Standard	+
			-
Quantity:			

CORE BLADE #2			
Dimension		Tolerance	
T		<input type="checkbox"/> Standard	+
			-
W		<input type="checkbox"/> Standard	+
			-
L		<input type="checkbox"/> Standard	+
			-
Quantity:			

CORE BLADE #3			
Dimension		Tolerance	
T		<input type="checkbox"/> Standard	+
			-
W		<input type="checkbox"/> Standard	+
			-
L		<input type="checkbox"/> Standard	+
			-
Quantity:			

CORE BLADE #4			
Dimension		Tolerance	
T		<input type="checkbox"/> Standard	+
			-
W		<input type="checkbox"/> Standard	+
			-
L		<input type="checkbox"/> Standard	+
			-
Quantity:			

E-MAIL TECH@PROCOMPS.COM		
CONTACT:	COMPANY NAME:	PHONE #:
REFERENCE #:	ACCOUNT #:	E-MAIL ADDRESS: