

EJECTOR SLEEVES

THIN WALL

STANDARD TOLERANCES		
D	+0.0003 -0.0000	+0.007 -0.000
B	-0.0004 -0.0007	-0.01 -0.02
L	+0.030 -0.000	+1.0 -0.0
N	+0.20 -0.00	+5.0 -0.0
S	+0.0 -0.1	+0.0 -3.0
G	+0.000 -0.001	+0.00 -0.02
H	+0.000 -0.010	+0.0 -0.2
T	+0.000 -0.002	+0.0 -0.05
	INCH	METRIC

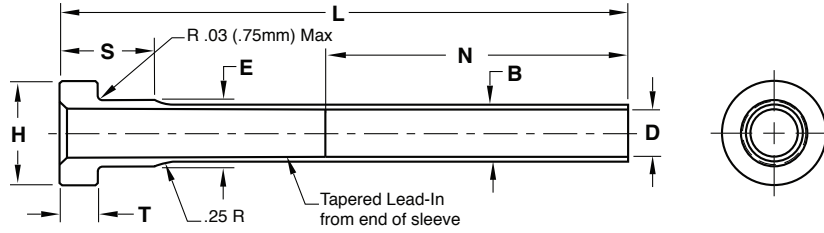

Material:

- M-2**
Core = 58-62 HRC (Thru Hard)
- H-13**
Core = 40-45 HRC
Surface = Nitrided ID/OD*

Treatment (ID/OD):

- Chrome
- Black Nitride
- Nicklon

Other:

Material	Core Hardness	Surface Hardness	Treatment

Note: *Nitriding IDOD may not be applicable on all sizes. Progressive will verify when quoting.

SLEEVE #1			
Dimension	Tolerance		
D	<input type="checkbox"/> Standard	+	
		-	
B	<input type="checkbox"/> Standard	+	
		-	
L	<input type="checkbox"/> Standard <input type="checkbox"/> Finished Length (+.001/- .000)	+	
		-	
N	<input type="checkbox"/> Standard	+	
		-	
S	<input type="checkbox"/> Standard	+	
		-	
E	<input type="checkbox"/> Standard	+	
		-	
H	<input type="checkbox"/> Standard	+	
		-	
T	<input type="checkbox"/> Standard	+	
		-	
Quantity:			

SLEEVE #2			
Dimension	Tolerance		
D	<input type="checkbox"/> Standard	+	
		-	
B	<input type="checkbox"/> Standard	+	
		-	
L	<input type="checkbox"/> Standard <input type="checkbox"/> Finished Length (+.001/- .000)	+	
		-	
N	<input type="checkbox"/> Standard	+	
		-	
S	<input type="checkbox"/> Standard	+	
		-	
E	<input type="checkbox"/> Standard	+	
		-	
H	<input type="checkbox"/> Standard	+	
		-	
T	<input type="checkbox"/> Standard	+	
		-	
Quantity:			

E-MAIL TECH@PROCOMPS.COM

CONTACT:	COMPANY NAME:	PHONE #:
REFERENCE #:	ACCOUNT #:	E-MAIL ADDRESS: