

GUIDE LOCKS

Z-SERIES™

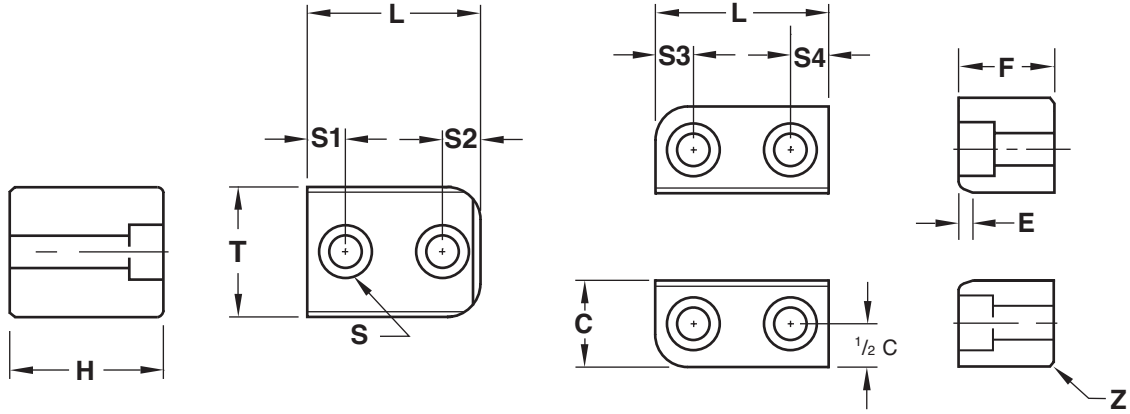

R1 (4) Each

Dual Radii Option
Guide Locks are also available with dual radii for mounting internally as shown at left.

Male Insert
Material = H-13
Core = 42-48 HRC
Surface = 70 HRC
Treatment = Salt Bath Nitride

Female Insert
Material = D-2
Core = 58-62 HRC
Surface = 80 HRC
Treatment = Titanium Nitride Coated

STANDARD TOLERANCES		
L	+0.000 -0.010	+0.00 -0.25
H	+0.00 -0.01	+0.0 -0.2
T	+0.0000 -0.0003	+0.00 -0.01
C	+0.0000 -0.0003	+0.00 -0.01
F	+0.000 -0.005	+0.00 -0.12
S1-4	±0.01	±0.2
	INCH	METRIC

GUIDE LOCK				E	<input type="checkbox"/> To Suit	Engagement Radius	S	SHCS		
Dimension	Tolerance									
L	<input type="checkbox"/> Standard	+	-	R1	<input type="checkbox"/> To Suit	Pocket Radius (Lock machined to suit)	Z	<input type="checkbox"/> Standard	+	-
H	<input type="checkbox"/> Standard	+	-	S1	<input type="checkbox"/> Standard		DUAL RADII <input type="checkbox"/> Yes <input type="checkbox"/> No			
T	<input type="checkbox"/> Standard	+	-	S2	<input type="checkbox"/> Standard		MALE QTY			
C	<input type="checkbox"/> Standard	+	-	S3	<input type="checkbox"/> Standard			FEMALE QTY		
F	<input type="checkbox"/> Standard	+	-	S4	<input type="checkbox"/> Standard					

E-MAIL TECH@PROCOMPS.COM		
CONTACT:	COMPANY NAME:	PHONE #:
REFERENCE #:	ACCOUNT #:	E-MAIL ADDRESS: