

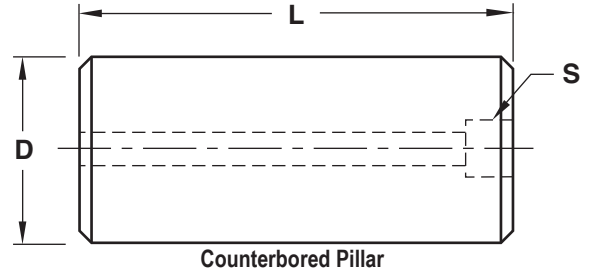

SUPPORT PILLARS

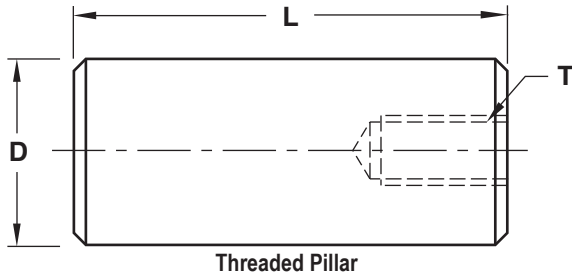

STANDARD TOLERANCES		
D	+0.005	+0.12
	-0.015	-0.25
L	+0.001	+0.01
	+0.002	+0.02
	INCH	METRIC

Thread	
D	Thread
Up to 2"	3/8-16
3+ up	5/8-11

Material:

- AISI-1018** **410 SS**
 Hardness = approx. 20 HRC Hardness = 30-34 HRC

Other:

Material	Core Hardness

THREADED PILLAR #1			
Dimension		Tolerance	
D		<input type="checkbox"/> Standard	+
			-
L		<input type="checkbox"/> Standard	+
			-
T			Thread
Quantity:			

COUNTERBORED PILLAR #1			
Dimension		Tolerance	
D		<input type="checkbox"/> Standard	+
			-
L		<input type="checkbox"/> Standard	+
			-
T			Clearance for SHCS
Quantity:			

THREADED PILLAR #2			
Dimension		Tolerance	
D		<input type="checkbox"/> Standard	+
			-
L		<input type="checkbox"/> Standard	+
			-
T			Thread
Quantity:			

COUNTERBORED PILLAR #2			
Dimension		Tolerance	
D		<input type="checkbox"/> Standard	+
			-
L		<input type="checkbox"/> Standard	+
			-
T			Clearance for SHCS
Quantity:			

E-MAIL TECH@PROCOMPS.COM		
CONTACT:	COMPANY NAME:	PHONE #:
REFERENCE #:	ACCOUNT #:	E-MAIL ADDRESS: